

REV. -	AUTH. R.L.	DATE 10/15/04	INITIAL RELEASE	APPROVED
REV. A	AUTH. M.R.	DATE 11/10/04	ADDED TOOLING HOLES	APPROVED

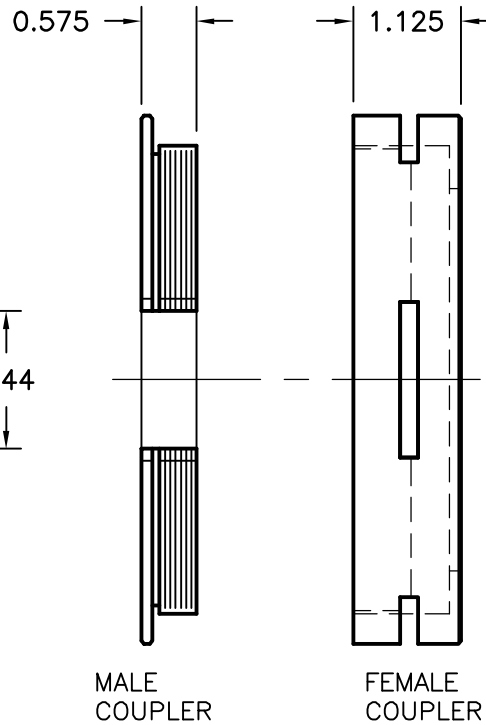
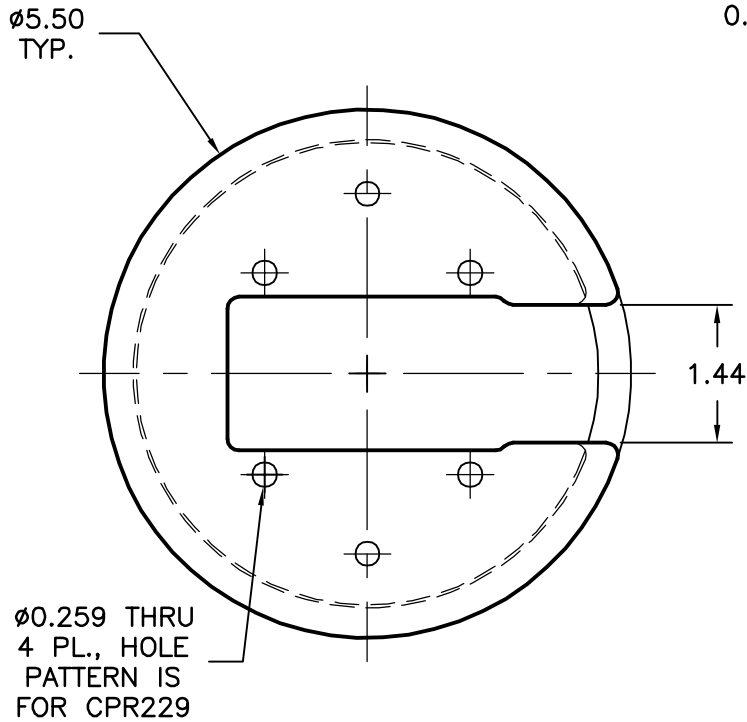

MAX. COMBINED FLANGE THICKNESS = 0.750"

NOTES:

1. THIS ASSY. FOR USE WITH CPR229-F/G FLANGES.
2. ASSEMBLY REQUIRES NYLON HARDWARE, TRIMMED TO LENGTH, SO AS NOT TO PROTRUDE PAST FACE OF TAPPED HOLE FLANGE.

MATERIAL ALUM.	TREATMENT -	DRAWN R. LYNCH	DATE 10/15/04
FINISH BLACK ANODIZE	MOD NO. QD-229	CHECKED	DATE
OUTLINE, WR229 QUICK DISCONNECT		APPROVED	DATE
		CAGE CODE: OR8N4	DO NOT SCALE DWG
ADVANCED TECHNICAL MATERIALS, INC. 49 RIDER AVE., PATCHOGUE N.Y. 11772 TEL: (631) 289-0363 FAX: (631) 289-0358 http://www.atmmicrowave.com		UNLESS OTHERWISE NOTED DIMENSIONS ARE IN INCHES TOLERANCES ARE:	FRACTIONS ±1/64 DECIMALS ±.01 ANGLES ±1/2°
<p>PROPRIETARY NOTICE: THE INFORMATION IN THIS DRAWING IS PROPRIETARY AND SHALL NOT BE USED OR DISCLOSED WITHOUT THE PRIOR WRITTEN CONSENT OF ATM, INC.</p>		SCALE 1 : 2	DWG. NO. 7036
			SHEET. 1/1
		REV. A	