

9-PIN CONNECTOR WIRING DIAGRAM (ATTENUATOR)		
PIN#	DESCRIP.	OPERATION
1	ØA	DECREASE PHASE
2	ØA	
3	ØB	INCREASE PHASE
4	ØB	
5	END POINT	OPTIONAL TRACKING WIPER 10K POTENTIOMETER (NOTE 1)
6	WIPER	
7	END POINT	

9-PIN D-SUB CONN. (F)

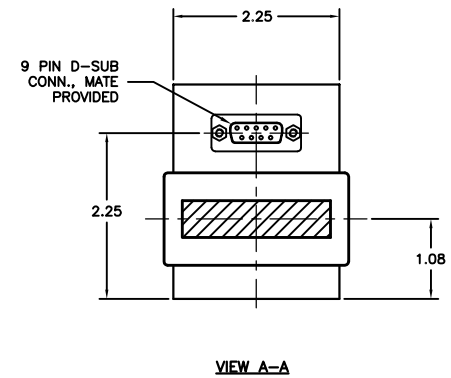
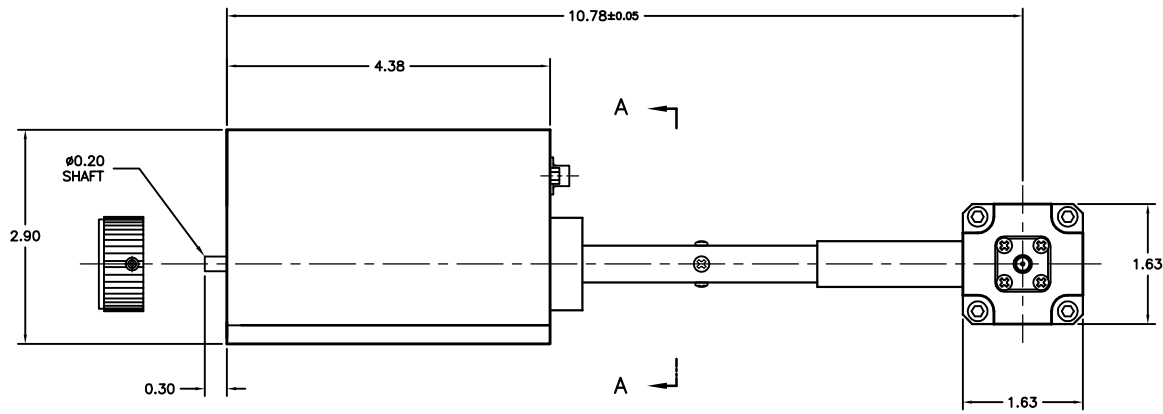

NOTES:

1. A 10K POT. WITH AN OUTPUT PROPORTIONAL TO THE POSITION OF THE MOTOR DRIVE MECHANISM IS AVAILABLE AT PINS 5, 6, AND 7.

APPLICATION TABLE	
MODEL#	FREQUENCY RANGE
P901-410-SM24	8.10-9.30 GHz
P901-411-SM24	9.10-10.20 GHz
P901-412-SM24	9.40-10.80 GHz
P901-413-SM24	10.50-11.90 GHz

THIRD ANGLE PROJECTION:		APPROVALS	DATE	ADVANCED TECHNICAL MATERIALS, INC. TEL: (631) 289-0363 FAX: (631) 289-0358 www.atmmicrowave.com		THE INFORMATION IN THIS DRAWING IS PROPRIETARY AND SHALL NOT BE USED OR DISCLOSED WITHOUT THE PRIOR WRITTEN CONSENT OF ATML, INC. DO NOT SCALE DWG.			
UNLESS OTHERWISE NOTED, DIMENSIONS ARE IN INCHES, TOLERANCES ARE: FRACTIONS: ±1/64 ANGLES: ±1/2° MACHINED FINISH 63 ✓ OR BETTER		DRAWN M.R.	06/08/15						
DECIMALS 2 PLACE 3 PLACE		CHKD.		PHASE SHIFTER STEPPER MOTOR DRIVEN		SIZE A	CAGE CODE OR8N4	ATM DWG # 16847	REVISION A
±.02	±.005	APRVD.				SCALE N.T.S.	MODEL # SEE TABLE	SHEET 1/1	
		MATERIAL ALUM BODY							
		TREATMENT CHEM FILM							
		FINISH ATM STD GRAY							