

2X 4-40 UNC  
0.25 DP

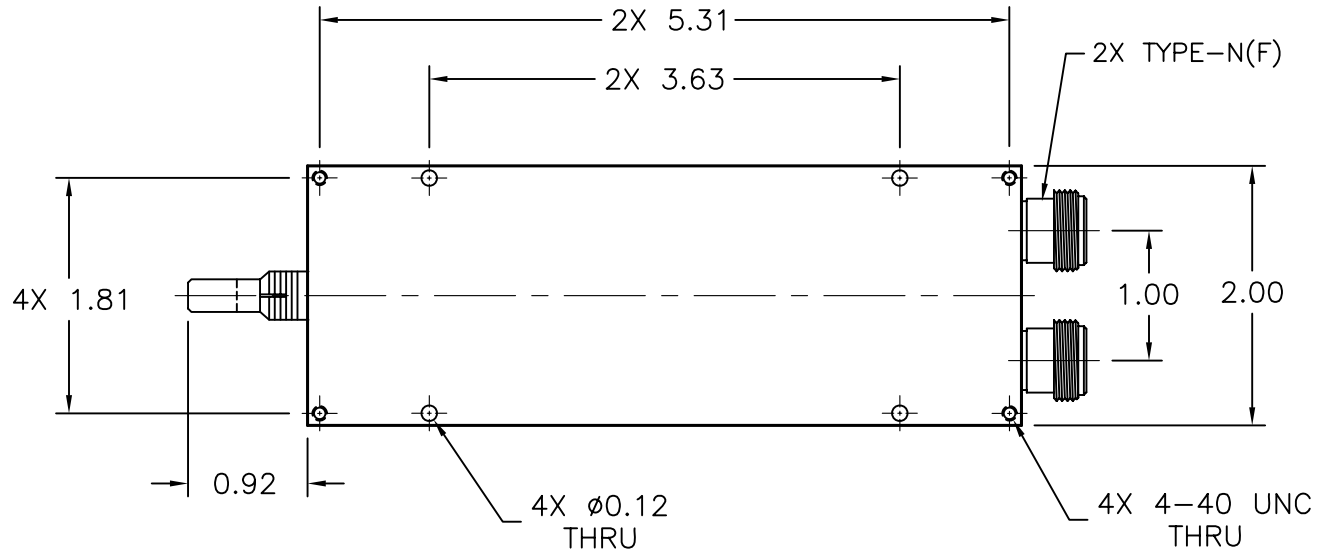

Ø.25 MULTI-TURN  
SLOTTED SHAFT

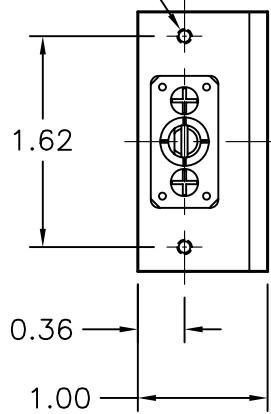
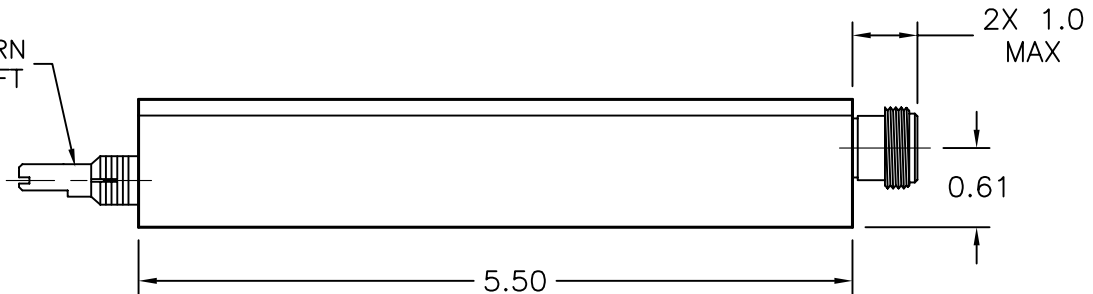

**NOTES:**

1. ALL STANDARD MODELS COME WITH LOCK NUT & KNOB
2. ALL MODELS HAVE AN RF POWER RATING OF 100W AVERAGE & 3 KW PEAK

THIRD ANGLE PROJECTION:		APPROVALS	DATE	<b>ADVANCED TECHNICAL MATERIALS, INC.</b> TEL: (631) 289-0363 FAX: (631) 289-0358 www.atmmicrowave.com		<small>THE INFORMATION IN THIS DRAWING IS PROPRIETARY AND SHALL NOT BE USED OR DISCLOSED WITHOUT THE PRIOR WRITTEN CONSENT OF ATM, INC. DO NOT SCALE DWG.</small>			
UNLESS OTHERWISE NOTED, DIMENSIONS ARE IN INCHES. TOLERANCES ARE:  FRACTIONS: ±1/64 ANGLES: ±1/2°  MACHINED FINISH 63 ✓ OR BETTER		DRAWN M.R.	4/19/11						
DECIMALS 2 PLACE   3 PLACE		CHKD.		<b>OUTLINE</b> 5.5" STD PHASESHIFTER, TYPE-N		SIZE A	CAGE CODE OR8N4	ATM DWG # 12720	REVISION A
±.01	±.005	APRVD.				SCALE 1 : 1	MODEL # P250XX	SHEET 1/1	
		MATERIAL -							
		TREATMENT CHEM FILM							
		FINISH ATM GRAY							