

-	RTK	12/15/00	INITIAL RELEASE
REV A	AUTH M.R.	DATE 11/30/15	APPLICATION TABLE ADDED, FORMAT UPDATE

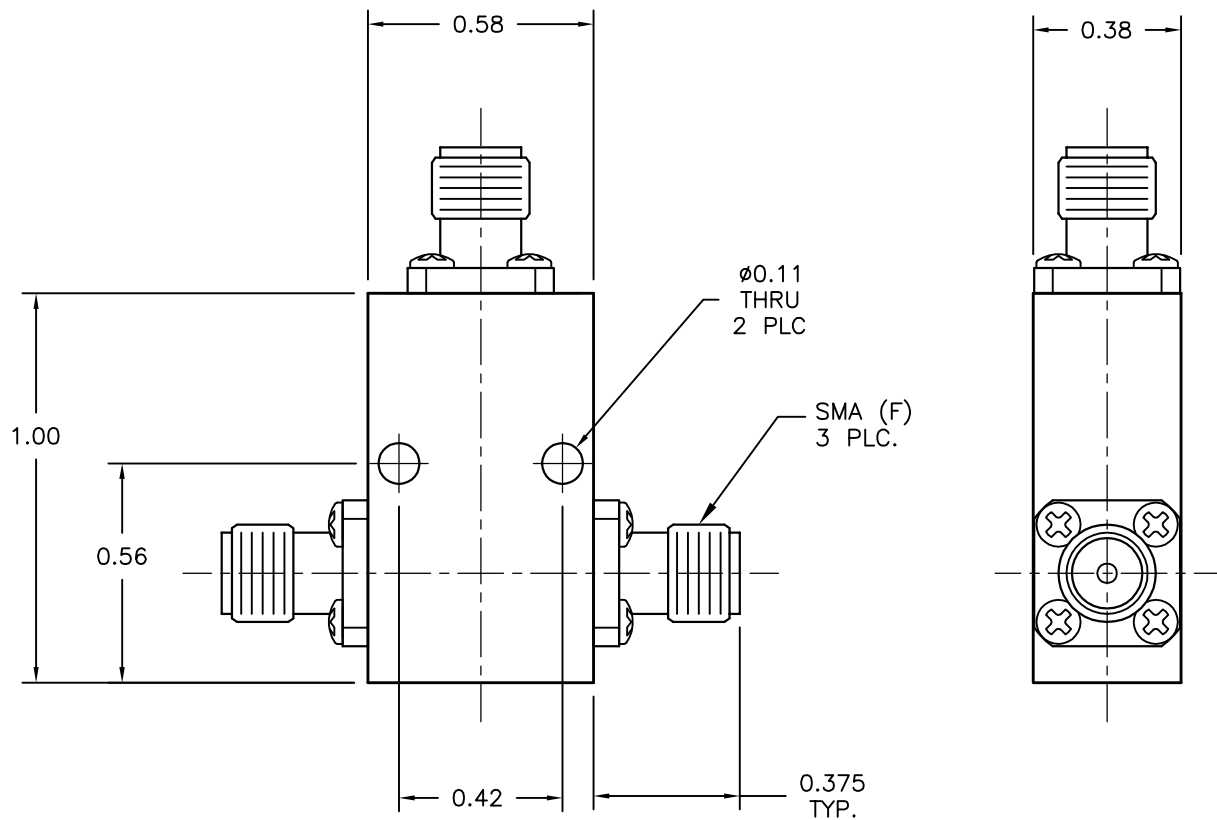

SPECIFICATIONS							
MODEL NUMBER	FREQ RANGE (GHz)	ISOLATION (dB)	VSWR		INS. LOSS (dB)	AMP. BAL. (+/- dB)	PHASE BAL. (+/- dB)
			IN	OUT			
P218	14.0-21.0	15	1.70	1.70	0.60	0.20	8.0
P218Ka/17-22.3	17.0-22.3	19	1.45	1.45	1.20	0.30	3.0

MECHANICAL SPECIFICATIONS

MATERIALS:
 BODY: 6061/T-6 ALUM.
 CONNECTORS: STAINLESS STEEL
 FINISH: UNIQUE CORROSION RESISTANT
 316 STAINLESS STEEL EPOXY COATING

THIRD ANGLE PROJECTION:	UNLESS OTHERWISE NOTED, DIMENSIONS ARE IN INCHES, TOLERANCES ARE: FRACTIONS: ±1/64 ANGLES: ±1/2° MACHINED FINISH 63 ✓ OR BETTER	APPROVALS DRAWN RTK CHKD. APRVD.	DATE 12/15/00	ADVANCED TECHNICAL MATERIALS, INC. TEL: (631) 289-0363 FAX: (631) 289-0358 www.atmmicrowave.com	THE INFORMATION IN THIS DRAWING IS PROPRIETARY AND SHALL NOT BE USED OR DISCLOSED WITHOUT THE PRIOR WRITTEN CONSENT OF ATM, INC. DO NOT SCALE DWG.	
	DECIMALS 2 PLACE 3 PLACE ±.01 ±.005	MATERIAL SEE SPECS TREATMENT CHEM FILM FINISH SEE SPECS	SIZE A SCALE 1 : 1			CAGE CODE OR8N4 ATM DWG # 2256W MODEL # SEE TABLE
	OUTLINE 2-WAY COAX. POWER DIVIDER					REVISION A
						SHEET 1/1