

REV -	AUTH RL	DATE 02/07/06	INITIAL RELEASE
REV A	AUTH RL	DATE 09/06/06	DIMENSIONS ADDED, CORRECTED DWG# WAS 6221W

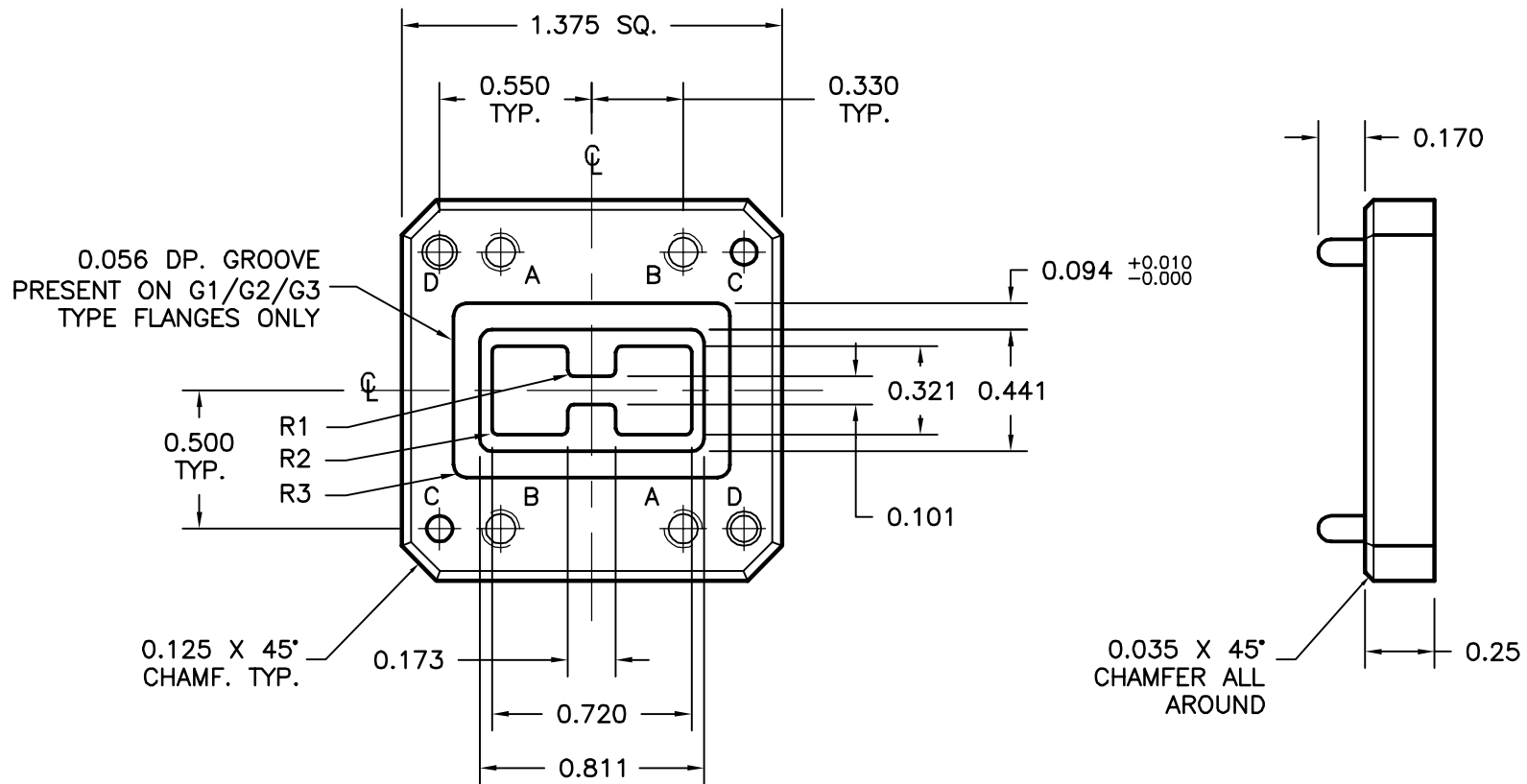

FLANGE TYPE	HOLE A	HOLE B
C1/G1	#6-32 UNC-2B	0.145 ± 0.003 / -0.000 THRU
C2/G2	#6-32 UNC-2B	#6-32 UNC-2B
C3/G3	0.145 ± 0.003 / -0.000 THRU	0.145 ± 0.003 / -0.000 THRU

HOLE C: $\phi 0.0938$ DOWEL PIN, 2 PLC.
HOLE D: $\phi 0.096$ THRU, 82°, C'SINK TO $\phi 0.125$, 2 PLC.
R1: 0.020 TYP.
R2: 0.027 TYP.
R3: 0.046 TYP.

THIRD ANGLE PROJECTION:		APPROVALS	DATE	ADVANCED TECHNICAL MATERIALS, INC. TEL: (631) 289-0363 FAX: (631) 289-0358 www.atmmicrowave.com		<small>THE INFORMATION IN THIS DRAWING IS PROPRIETARY AND SHALL NOT BE REPRODUCED OR DISCLOSED WITHOUT THE PRIOR WRITTEN CONSENT OF ATM, INC. DO NOT SCALE DWG.</small>	
UNLESS OTHERWISE NOTED, DIMENSIONS ARE IN INCHES, TOLERANCES ARE: FRACTIONS: $\pm 1/64$ ANGLES: $\pm 1/2^\circ$		DRAWN RL	02/07/06	<h2 style="text-align: center;">WRD650 FLANGE</h2>			
BASIC DIMENSION		CHKD.	APRVD.				
UNDER 6"	DECIMALS 2 PLACE 3 PLACE	MATERIAL PER ORDER					
6" - 12"	± 0.02 ± 0.005	TREATMENT -		SIZE A	CAGE CODE OR8N4	ATM DWG # 6621W	REVISION A
OVER 12"	± 0.03 ± 0.010	FINISH -		SCALE NONE	MODEL # -		SHEET 1/1
	± 0.06 ± 0.015						