

REV A	AUTH RL	DATE 10/10/07	INITIAL RELEASE
REV B	AUTH M.R.	DATE 7/23/09	HOLE DATA CORRECTED, C2/G2 WAS 0.171 THRU, C3/G3 WAS 8-32 THRU.
REV C	AUTH M.R.	DATE 5/25/10	ADDED MISSING DIMENSION $\triangle C1$

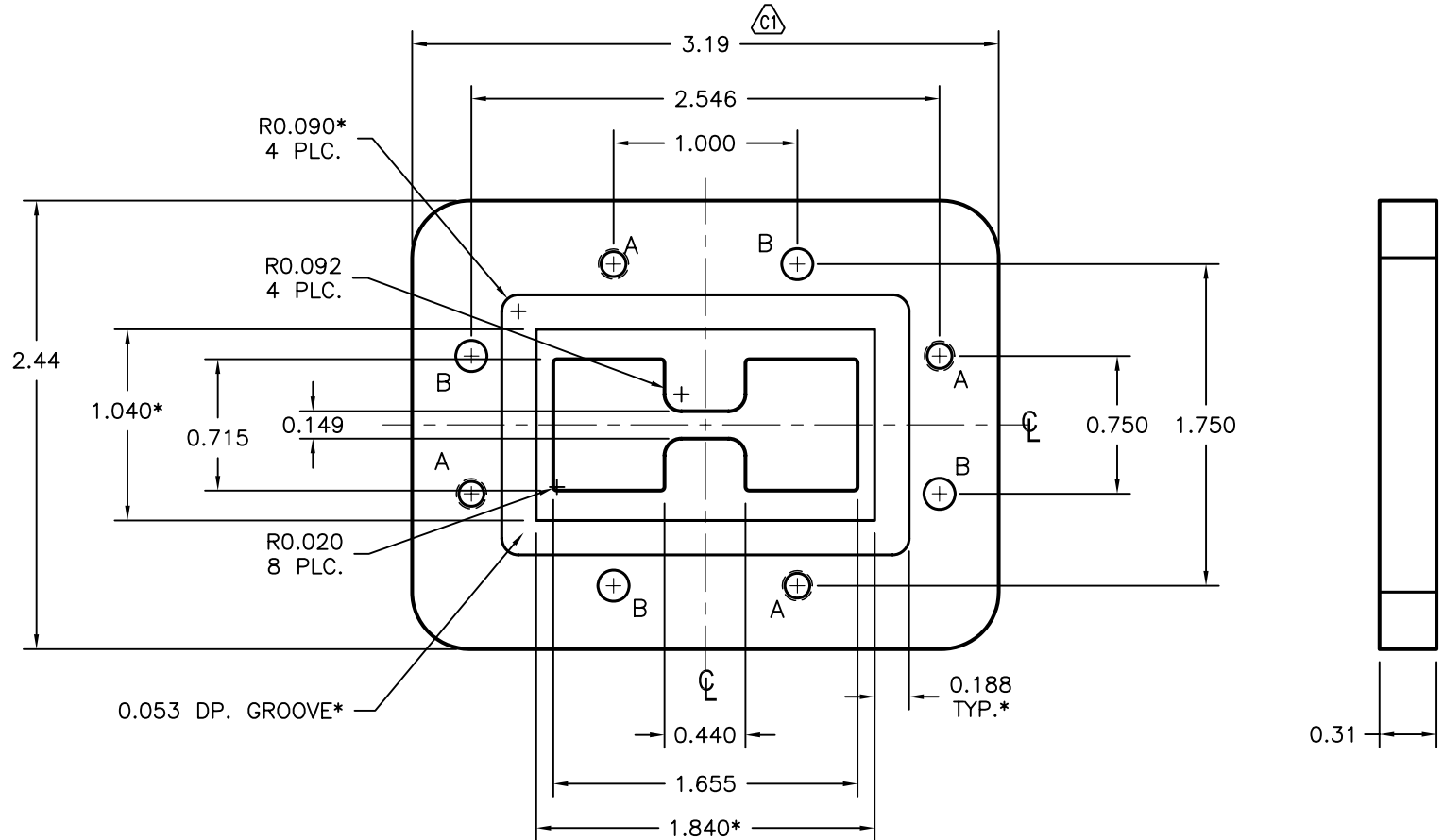

NOTE:

1. DIMS MARKED "*" APPLY TO G1/G2/G3 (GROOVED) FLANGES ONLY.

FLANGE TYPE	HOLE A	HOLE B
C1/G1	#8-32 UNC-2B	0.171 ± 0.002 THRU
C2/G2	#8-32 UNC-2B	#8-32 UNC-2B
C3/G3	0.171 ± 0.002 THRU	0.171 ± 0.002 THRU

THIRD ANGLE PROJECTION:		APPROVALS	DATE	ADVANCED TECHNICAL MATERIALS, INC. TEL: (631) 289-0363 FAX: (631) 289-0358 www.atmmicrowave.com		<small>THE INFORMATION IN THIS DRAWING IS PROPRIETARY AND SHALL NOT BE USED OR DISCLOSED WITHOUT THE PRIOR WRITTEN CONSENT OF ATM, INC. DO NOT SCALE DWG.</small>	
UNLESS OTHERWISE NOTED, DIMENSIONS ARE IN INCHES. TOLERANCES ARE: FRACTIONS: $\pm 1/64$ ANGLES: $\pm 1/2^\circ$		DRAWN RL	10/10/07				
		CHKD.		<h1>WRD250 FLANGE</h1>			
		APRVD.					
BASIC DIMENSION	DECIMALS 2 PLACE 3 PLACE	MATERIAL PER ORDER		SIZE A	CAGE CODE 0R8N4	ATM DWG # 6901W	REVISION C
UNDER 6"	$\pm .02$ $\pm .005$	TREATMENT -		SCALE	1 : 1	MODEL # WRD250	SHEET 1/1
6" - 12"	$\pm .03$ $\pm .010$	FINISH -					
OVER 12"	$\pm .06$ $\pm .015$						