

REV -	AUTH RL	DATE 02/01/06	INITIAL RELEASE
REV A	AUTH M.R.	DATE 07/11/13	HOLE CALL-OUT TYPO CORRECTED (LOWER LEFT WAS "A")
REV B	AUTH RL	DATE 12/22/14	SEE ECN # 12-22-14-01

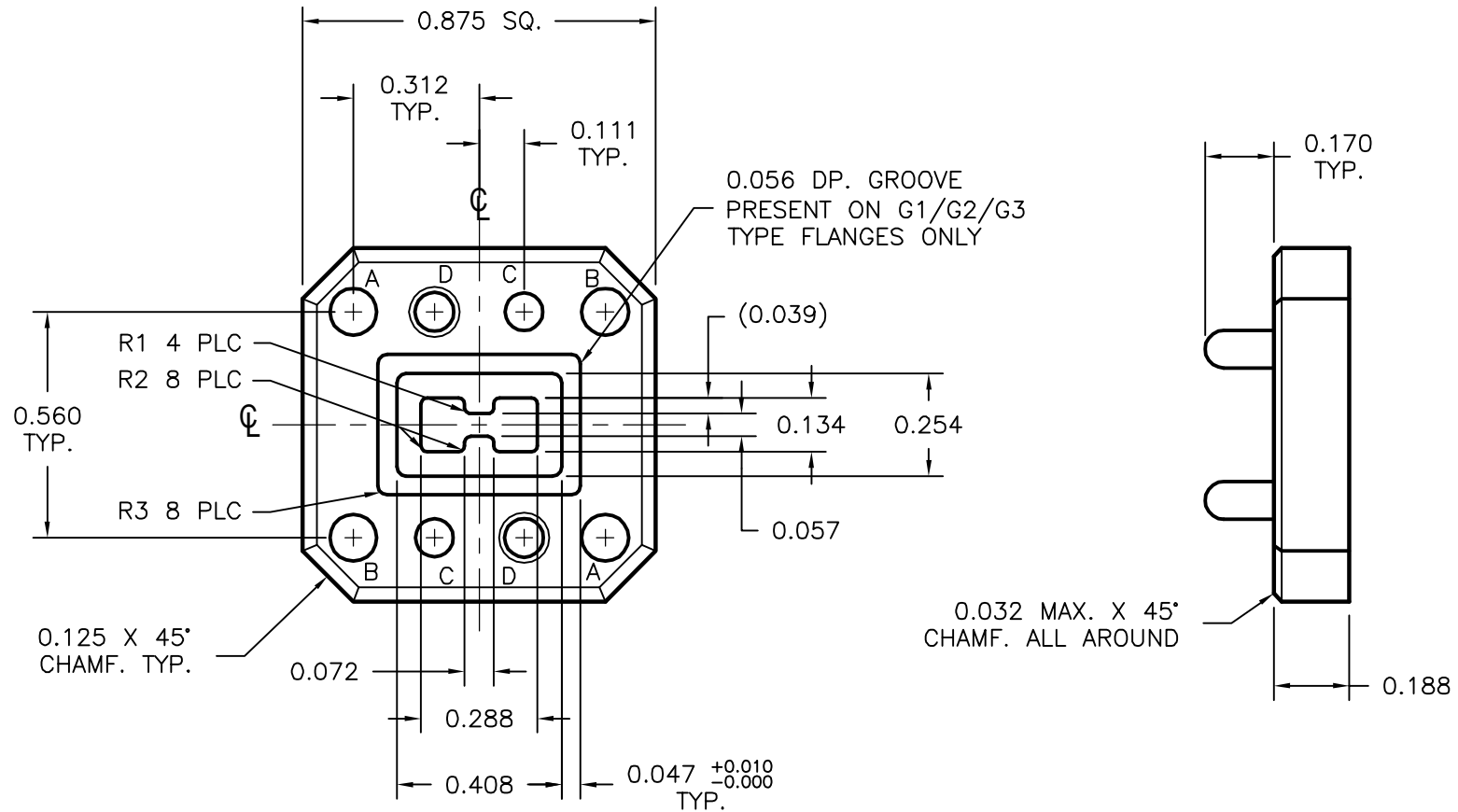

R1: 0.011 TYP.
R2: 0.020 TYP.
R3: 0.046 TYP.

FLANGE TYPE	HOLE A	HOLE B
C1/G1	#4-40 UNC-2B	0.117 ^{+0.002} / _{-0.001} THRU
C2/G2	#4-40 UNC-2B	#4-40 UNC-2B
C3/G3	0.117 ^{+0.002} / _{-0.001} THRU	0.117 ^{+0.002} / _{-0.001} THRU

HOLE C: $\varnothing 0.0938$ DOWEL PIN, 2 PLC.
HOLE D: $\varnothing 0.096$ THRU, 82°, C'SINK TO $\varnothing 0.125$, 2 PLC.

THIRD ANGLE PROJECTION:		APPROVALS	DATE	ADVANCED TECHNICAL MATERIALS, INC. TEL: (631) 289-0363 FAX: (631) 289-0358 www.atmmicrowave.com		<small>THE INFORMATION IN THIS DRAWING IS PROPRIETARY AND SHALL NOT BE USED OR DISCLOSED WITHOUT THE WRITTEN CONSENT OF ATM, II DO NOT SCALE DWG.</small>	
UNLESS OTHERWISE NOTED, DIMENSIONS ARE IN INCHES, TOLERANCES ARE: FRACTIONS: $\pm 1/64$ ANGLES: $\pm 1/2^\circ$		DRAWN RL	02/01/06	WRD180 FLANGE			
BASIC DIMENSION		CHKD.	APRVD.	MATERIAL -		SIZE A	REVISION B
DECIMALS 2 PLACE				TREATMENT -		CAGE CODE 0R8N4	ATM DWG # 6900W
3 PLACE				FINISH -		SCALE 2 : 1	MOD # WRD180
UNDER 6"	$\pm .02$	$\pm .005$					SHEET 1/1
6" - 12"	$\pm .03$	$\pm .010$					
OVER 12"	$\pm .06$	$\pm .015$					