

REV -	AUTH DRH	DATE 12/15/04	INITIAL RELEASE
REV A	AUTH RL	DATE 01/21/05	THICKNESS: .38, WAS: .25
REV B	AUTH RL	DATE 03/25/06	DIMENSIONAL ERROR CORRECTED: 3.828 WAS: 3.818

EQUIVALENT TO:	
TYPE	MATERIAL
UG 1725/U	ALUMINUM
UG 1724/U	BRASS

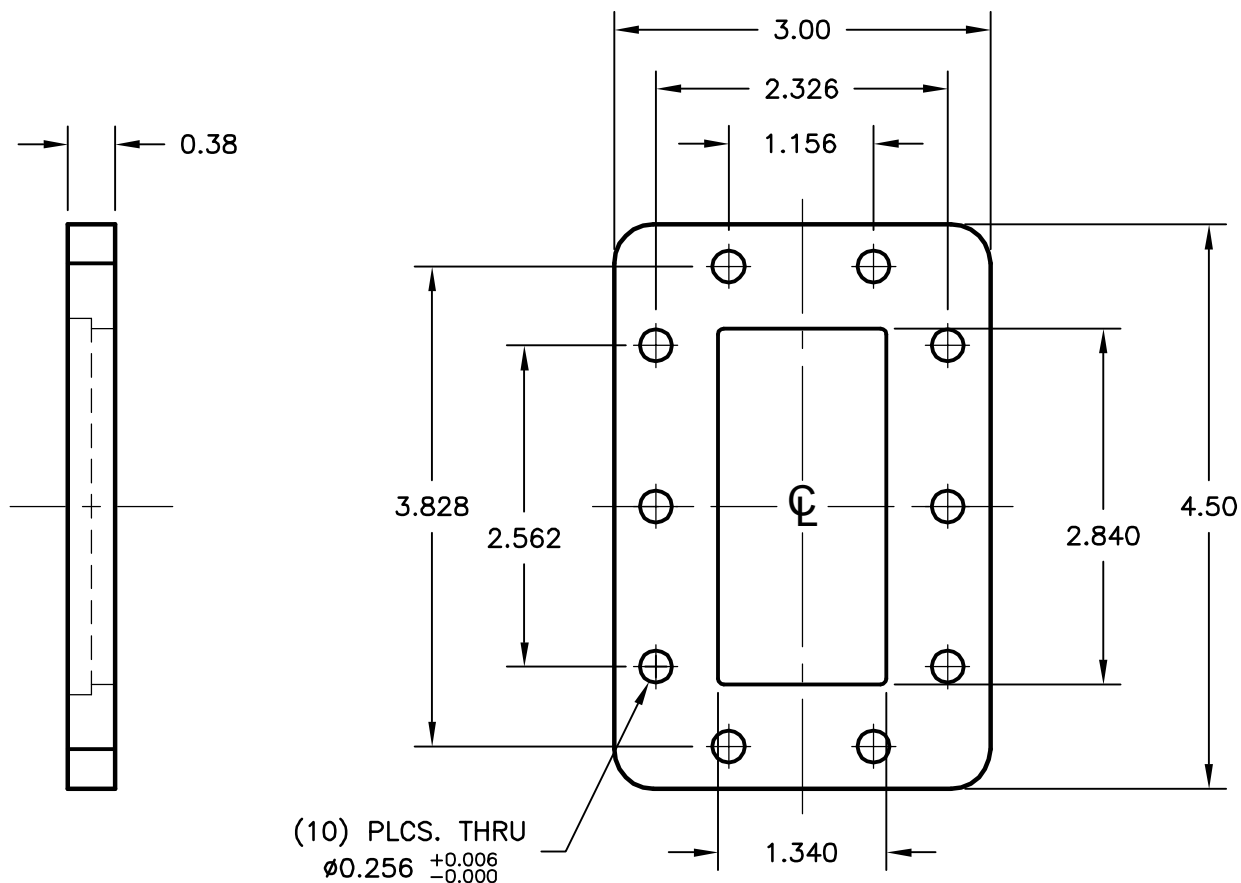

NOTES:

1. ALL DRAWINGS INDICATE APPLICABLE MATING DIMENSIONS. NON INTERFACE VARIABLES SUCH AS THICKNESS, CORRAL DIMENSIONS, AND MATERIALS MAY VARY DEPENDING ON PRODUCT CONFIGURATION.

THIRD ANGLE PROJECTION:		APPROVALS		DATE		ADVANCED TECHNICAL MATERIALS, INC. TEL: (631) 289-0363 FAX: (631) 289-0358 www.atmmicrowave.com		<small>THE INFORMATION IN THIS DRAWING IS PROPRIETARY AND SHALL NOT BE USED OR DISCLOSED WITHOUT THE PRIOR WRITTEN CONSENT OF ATM, INC. DO NOT SCALE DWG.</small>				
UNLESS OTHERWISE NOTED, DIMENSIONS ARE IN INCHES. TOLERANCES ARE: FRACTIONS: $\pm 1/64$ ANGLES: $\pm 1/2^\circ$		DRAWN RL		03/25/06								
BASIC DIMENSION		DECIMALS 2 PLACE 3 PLACE		APRVD.		WR284 FLANGE STANDARD CPR284F						
UNDER 6"	$\pm .02$	$\pm .005$	MATERIAL PER ORDER		SIZE A					CAGE CODE OR8N4	ATM DWG # 7076W	REVISION B
6" - 12"	$\pm .03$	$\pm .010$	TREATMENT -		SCALE NONE					MODEL # -	SHEET 1/1	
OVER 12"	$\pm .06$	$\pm .015$	FINISH -									