

REV	AUTH	DATE	INITIAL RELEASE
-	-	02/06/06	
A	-	03/03/09	GROOVE DEPTH CORRECTED, WAS 0.053 $\triangle A1$

MATERIAL	EQUIVALENT TO:	
BRASS	UG 1356/U	MIL-F-3922-52-039
ALUM.	UG 1357/U	MIL-F-3922-52-040

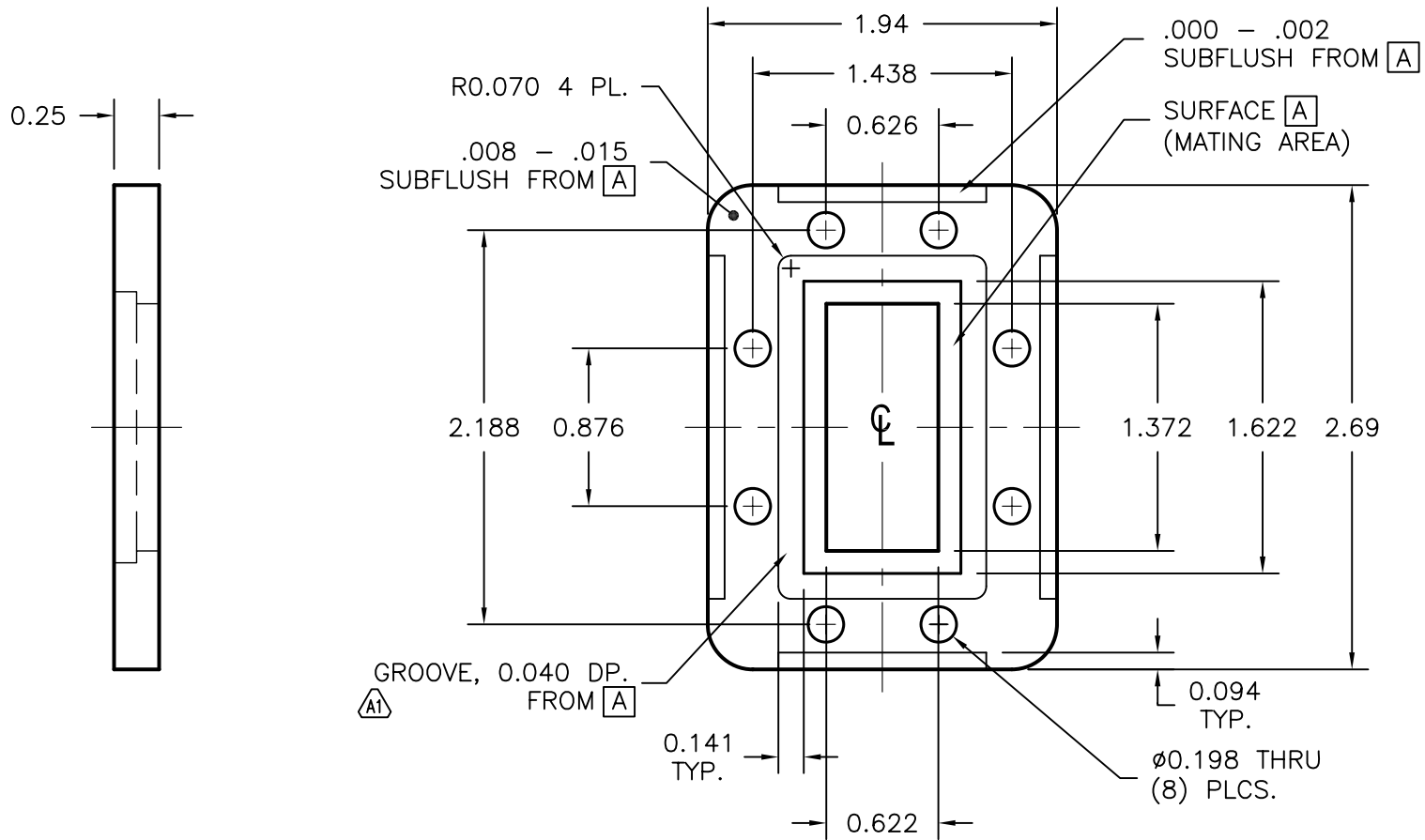

NOTES:

- ALL DRAWINGS INDICATE APPLICABLE MATING DIMENSIONS. NON INTERFACE VARIABLES SUCH AS THICKNESS, CORRAL DIMENSIONS, AND MATERIALS MAY VARY DEPENDING ON PRODUCT CONFIGURATION.

THIRD ANGLE PROJECTION:		APPROVALS	DATE		ADVANCED TECHNICAL MATERIALS, INC. TEL: (631) 289-0363 FAX: (631) 289-0358 www.atmmicrowave.com	THE INFORMATION IN THIS DRAWING IS PROPRIETARY AND SHALL NOT BE USED OR DISCLOSED WITHOUT THE PRIOR WRITTEN CONSENT OF ATM, INC. DO NOT SCALE DWG.				
UNLESS OTHERWISE NOTED, DIMENSIONS ARE IN INCHES. TOLERANCES ARE: FRACTIONS: $\pm 1/64$ ANGLES: $\pm 1/2^\circ$		DRAWN RL	02/27/07							
BASIC DIMENSION		CHKD.	APRVD.	WR137 FLANGE, CPR137G						
DECIMALS 2 PLACE 3 PLACE		MATERIAL SEE NOTES								
UNDER 6"	$\pm .02$ $\pm .005$	TREATMENT -					SIZE A	CAGE CODE OR8N4	ATM DWG # 7236W	REVISION A
6" - 12"	$\pm .03$ $\pm .010$	FINISH -					SCALE 1 : 1	MODEL # -	SHEET 1/1	
OVER 12"	$\pm .06$ $\pm .015$									