

REV -	AUTH RL	DATE 05/24/06	INITIAL RELEASE
REV A	AUTH M.R.	DATE 09/02/09	ADDED FLANGE TYPE HOLE CHART

FLANGE TYPE	HOLE A	HOLE B
-3	#6-32 UNC-2B	0.145 ± 0.003 THRU
-4	0.145 ± 0.003 THRU	0.145 ± 0.003 THRU
-5	#6-32 UNC-2B	#6-32 UNC-2B

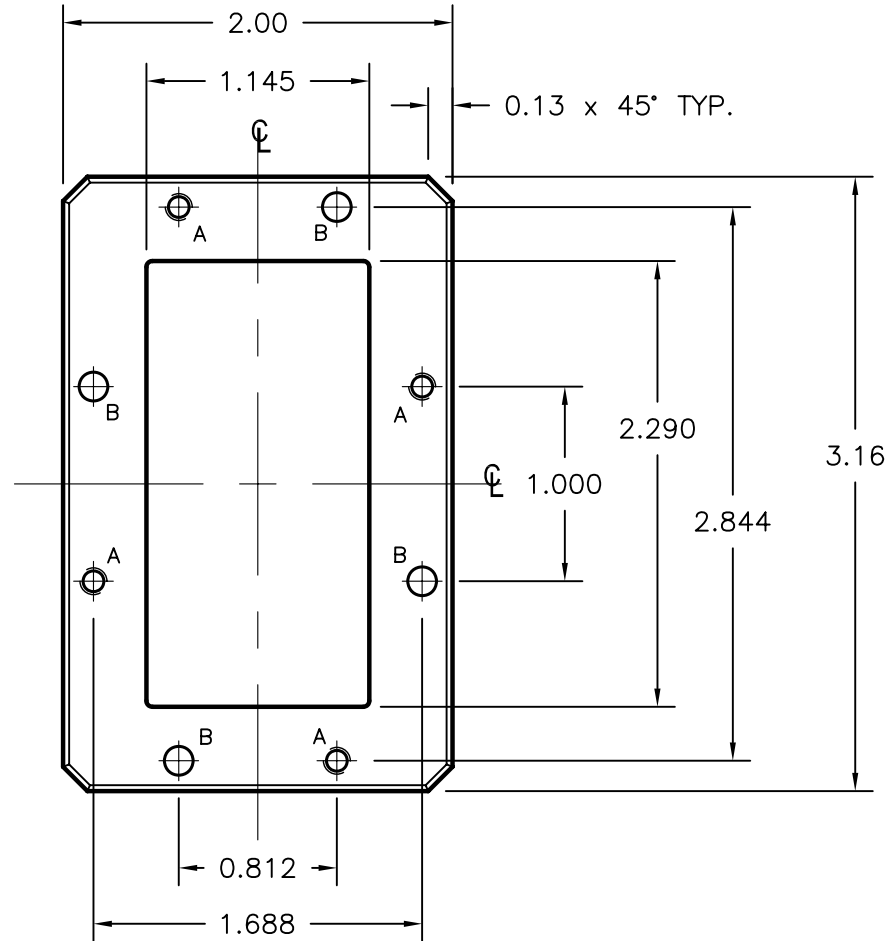
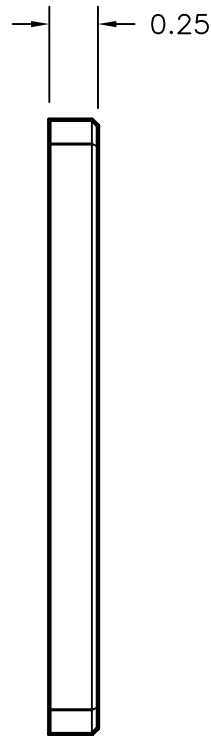

NOTES:

- ALL DRAWINGS INDICATE APPLICABLE MATING DIMENSIONS. NON INTERFACE VARIABLES SUCH AS THICKNESS, CORRAL DIMENSIONS, AND MATERIALS MAY VARY DEPENDING ON PRODUCT CONFIGURATION.

THIRD ANGLE PROJECTION:		APPROVALS	DATE	ADVANCED TECHNICAL MATERIALS, INC. TEL: (631) 289-0363 FAX: (631) 289-0358 www.atmmicrowave.com		<small>THE INFORMATION IN THIS DRAWING IS PROPRIETARY AND SHALL NOT BE USED OR DISCLOSED WITHOUT THE PRIOR WRITTEN CONSENT OF ATM, INC. DO NOT SCALE DWG.</small>	
UNLESS OTHERWISE NOTED, DIMENSIONS ARE IN INCHES. TOLERANCES ARE: FRACTIONS: $\pm 1/64$ ANGLES: $\pm 1/2^\circ$		DRAWN RL	05/24/06	<h1>CPR229 FLANGE</h1>			
		CHKD.					
		APRVD.					
BASIC DIMENSION	DECIMALS 2 PLACE 3 PLACE	MATERIAL PER ORDER		SIZE A	CAGE CODE OR8N4	ATM DWG # 7230W	REVISION A
UNDER 6"	$\pm .02$ $\pm .005$			SCALE	1 : 1	MODEL # -	SHEET 1/1
6" - 12"	$\pm .03$ $\pm .010$	TREATMENT -					
OVER 12"	$\pm .06$ $\pm .015$	FINISH -					