

REV -	AUTH RTK	DATE 04/19/00	INITIAL RELEASE
REV A	AUTH RL	DATE 07/25/06	FORMAT UPDATE; SPECS ADDED, $\triangle A1$ KNOB WAS $\phi 1.25"$ $\triangle A2$ WAS: 3.00"

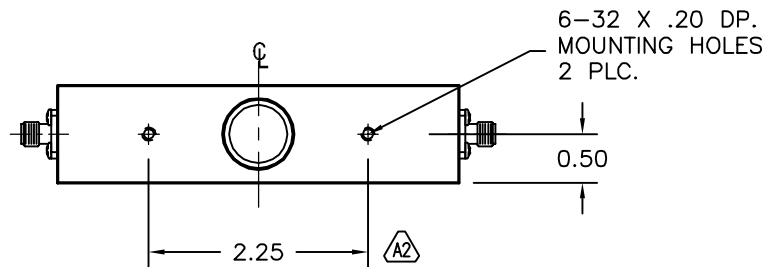
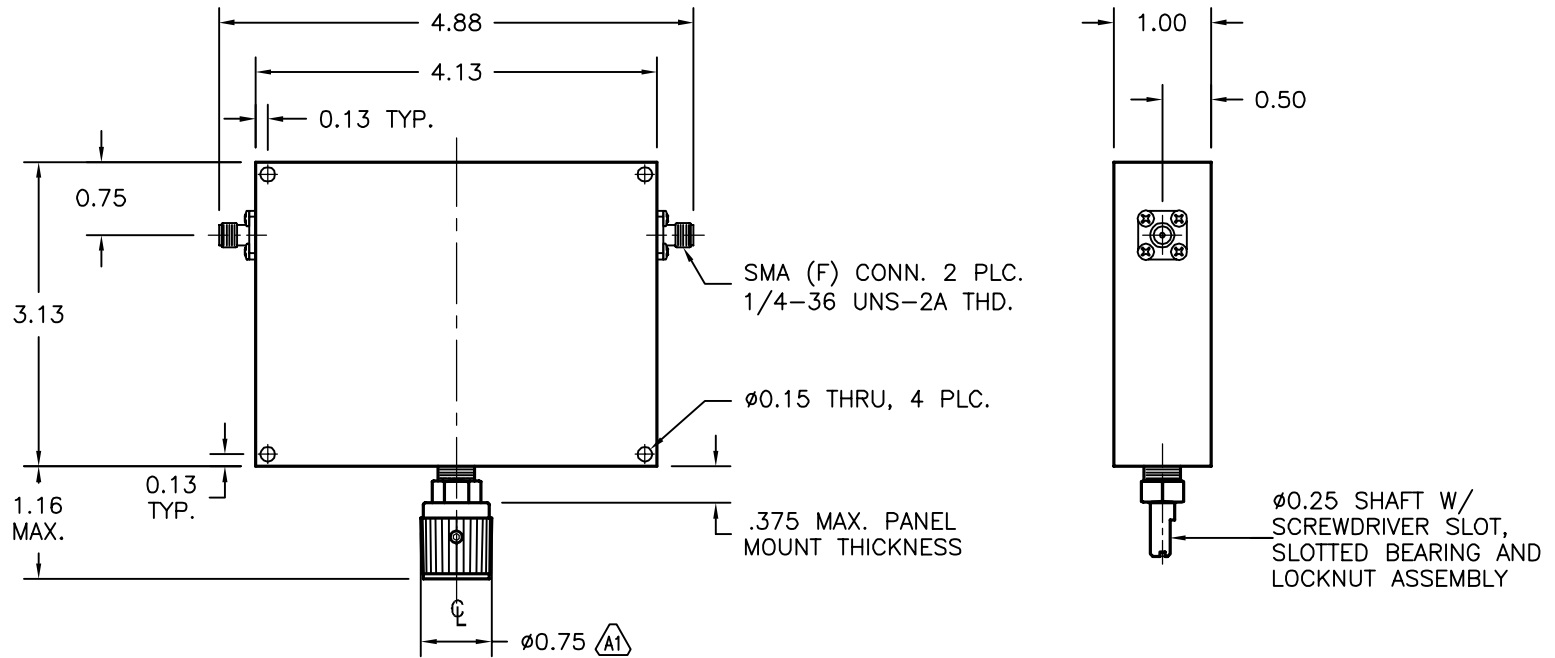

**MODEL SPECIFICATIONS**

**MECHANICAL**

MODEL NUMBER(S): AV262D-40  
AV262E-40

MATERIAL:  
BODY: 6061/T-6 ALUM.  
CONNECTORS: STAINLESS STEEL  
FINISH: UNIQUE CORROSION RESISTANT  
316 STAINLESS STEEL EPOXY  
COATING  
CONNECTORS: SMA-FEMALE

**ELECTRICAL**

FREQ. RANGE:  
AV262D-40 0.85 - 2.5 GHz  
AV262E-40 0.85 - 4.0 GHz  
VSWR: 1.5 MAX.  
ATTENUATION RANGE: 40dB  
INSERTION LOSS: 0.5dB MAX.

THIRD ANGLE PROJECTION:		APPROVALS	DATE	ADVANCED TECHNICAL MATERIALS, INC. TEL: (631) 289-0363 FAX: (631) 289-0358 www.atmmicrowave.com		<small>THE INFORMATION IN THIS DRAWING IS PROPRIETARY AND SHALL NOT BE USED OR DISCLOSED WITHOUT THE PRIOR WRITTEN CONSENT OF ATMI, INC. DO NOT SCALE DWG.</small>			
UNLESS OTHERWISE NOTED, DIMENSIONS ARE IN INCHES, TOLERANCES ARE: FRACTIONS: $\pm 1/64$ ANGLES: $\pm 1/2^\circ$				DRAWN RL	07/25/06	<b>OUTLINE,</b> <b>AV262X-40 ATTENUATOR, SMA</b>			
BASIC DIMENSION		DECIMALS 2 PLACE	3 PLACE	CHKD.				SIZE A	CAGE CODE 0R8N4
UNDER 6"	$\pm .02$	$\pm .005$		APRVD.				ATM DWG #	2632W
6" - 12"	$\pm .03$	$\pm .010$		MATERIAL	SEE SPECS	REVISION	A		
OVER 12"	$\pm .06$	$\pm .015$		TREATMENT	-	SCALE	1 : 2		
				FINISH	SEE SPECS	MODEL #	SEE SPECS		
						SHEET	1/1		