

REV A	AUTH M.R.	DATE 06/30/15	INITIAL RELEASE
REV B	AUTH M.R.	DATE 03/29/17	UPDATED CONNECTOR ILLUSTRATION TO SCREW-IN TYPE. FORMAT UPDATE

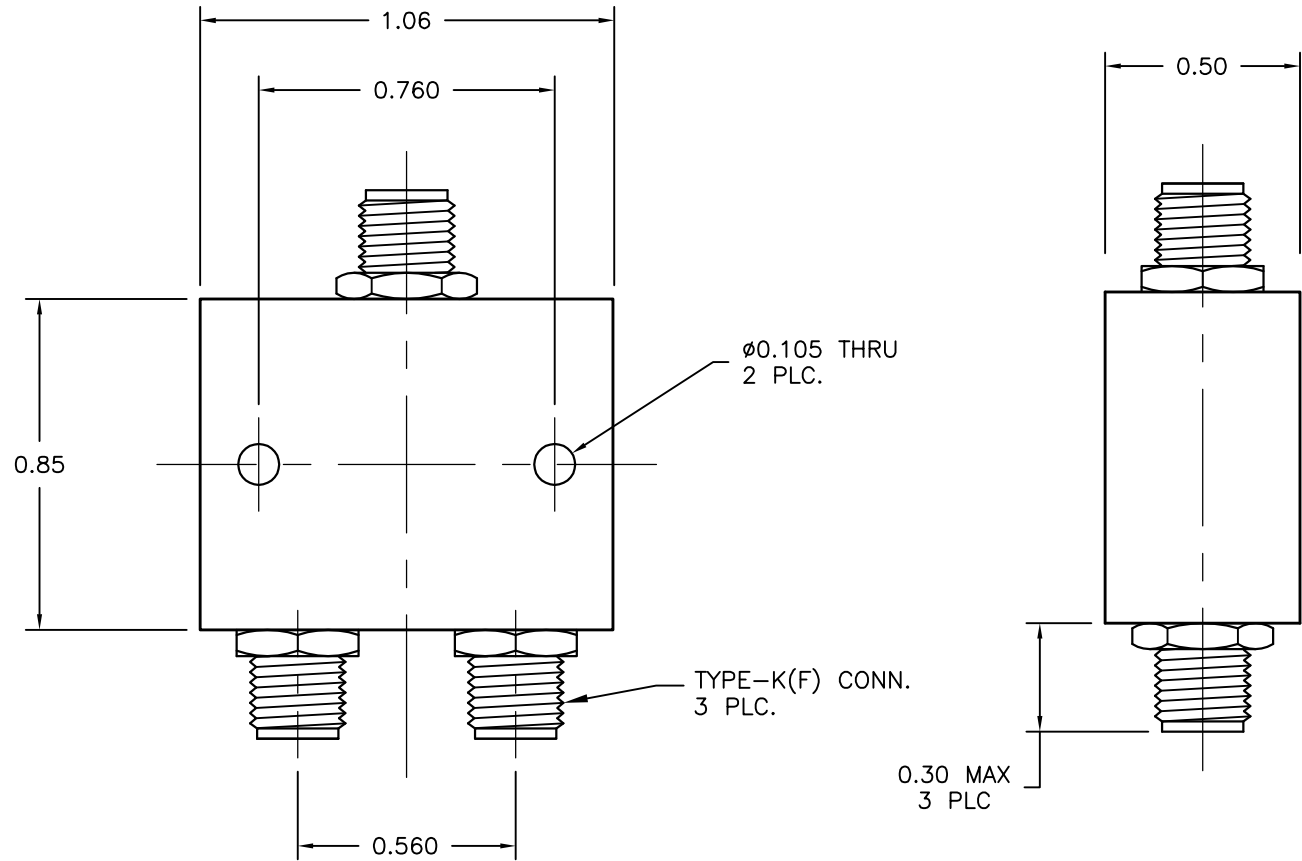

MODEL SPECIFICATIONS

MECHANICAL

MODEL NUMBER: P219Ka
 MATERIAL: 6061/T-6 ALUM.
 BODY: STAINLESS STEEL
 CONNECTORS: UNIQUE CORROSION RESISTANT
 FINISH: 316 STAINLESS STEEL EPOXY COATING
 SPECIAL, PER CUSTOMER DWG.

ELECTRICAL

FREQ. RANGE: 27.5 - 31.0 GHz
 VSWR MAX.: 1.6:1
 IN: 1.5:1
 OUT: 20dB
 ISOLATION: 1.5dB
 INSERTION LOSS: ±.30 dB
 AMP. BALANCE ±4.0 dB
 PHASE BALANCE

THIRD ANGLE PROJECTION:		APPROVALS	DATE			L-3 Narda - ATM TEL: (631) 289-0363 FAX: (631) 289-0358 www.atmmicrowave.com		<small>THE INFORMATION IN THIS DRAWING IS PROPRIETARY AND SHALL NOT BE USED OR DISCLOSED WITHOUT THE WRITTEN CONSENT OF ATM, IN DO NOT SCALE DWG.</small>	
UNLESS OTHERWISE NOTED, DIMENSIONS ARE IN INCHES. TOLERANCES ARE: FRACTIONS: ±1/64 ANGLES: ±1/2° MACHINED FINISH 63 ✓ OR BETTER		DRAWN M.R.	06/30/15	OUTLINE, P219Ka 2-WAY POWER DIVIDER		SIZE A CAGE CODE 0R8N4 ATM DWG # 16829 REVISION B		SCALE 2 : 1 MODEL # P219Ka SHEET 1/1	
DECIMALS 2 PLACE 3 PLACE		CHKD.							
±.01 ±.005		APRVD.		MATERIAL SEE NOTES		TREATMENT -		FINISH SEE NOTES	