

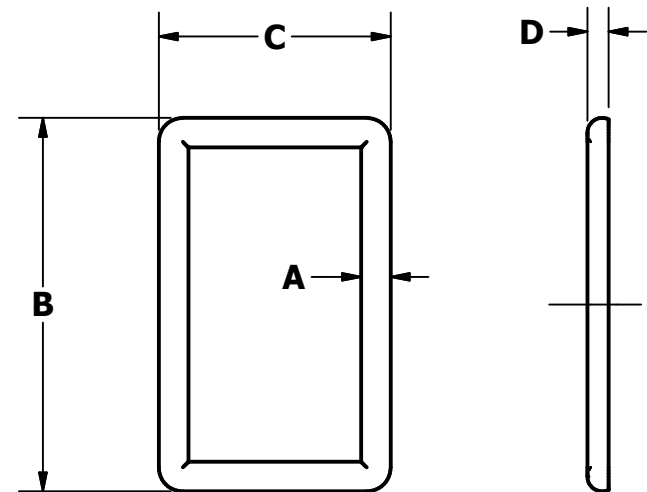

REVISION HISTORY

REV	AUTH	DATE	DESCRIPTION
A	RL	01-10-17	INITIAL RELEASE
B	RL	6-19-19	TABLE REVISION PER ECN #6-19-19-1
C	RL	6-26-19	TABLE REVISION PER ECN #6-26-19-1

W/G SIZE	A	B	C	D	MODEL# (NON-CONDUCTIVE)	MODEL# (CONDUCTIVE)
WRD250	.150	2.155	1.353	.066	G250AGH	G250BGH
WRD350	.095	1.953	1.163	.060	G350AGH	G350BGH
WRD475	.077	1.381	.797	.070	G475AGH	G475BGH
WRD580	.094	1.093	.693	.067	G580AGH	G580BGH
WRD650	.077	1.004	.634	.067	G650AGH	G650BGH
WRD750	.077	1.004	.634	.067	G750AGH	G750BGH
WRD180	.060	.493	.341	.052	G180AGH	G180BGH



THIRD ANGLE PROJECTION:		DRAWN: RL DATE: 1-10-2017	 L3-NARDA-ATM 49 Rider Ave, Patchogue, NY 11772 TEL: (631) 289-0363 FAX: (631) 289-0358 www.atmmicrowave.com CAGE CODE: 0R8N4	THE INFORMATION IN THIS DRAWING IS PROPRIETARY AND SHALL NOT BE USED OR DISCLOSED WITHOUT THE PRIOR WRITTEN CONSENT OF L3 NARDA-ATM, INC.
UNLESS OTHERWISE NOTED, DIMENSIONS ARE IN INCHES, TOLERANCES ARE: FRACTIONS: ±1/64 ANGLES: ±1/2°		CHKD. _____ APRVD. _____		
DECIMALS 2 PLACE 3 PLACE ±.01 ±.005		MATERIAL PER ORDER	GASKET, D-SECTION WRD FLANGE TYPES	
SHEET SIZE: A	SHEET #: 1 OF 1	TREATMENT		
		FINISH	MODEL # SEE NOTE	ATM DWG # 18396
		SURFACE FINISH: 63 √ OR BETTER	REVISION C	



B

B

A

A