

REV A	AUTH L.M.	DATE 08/07/14	INITIAL RELEASE
REV B	AUTH RL	DATE 02/06/15	VSWR SPEC UPDATE

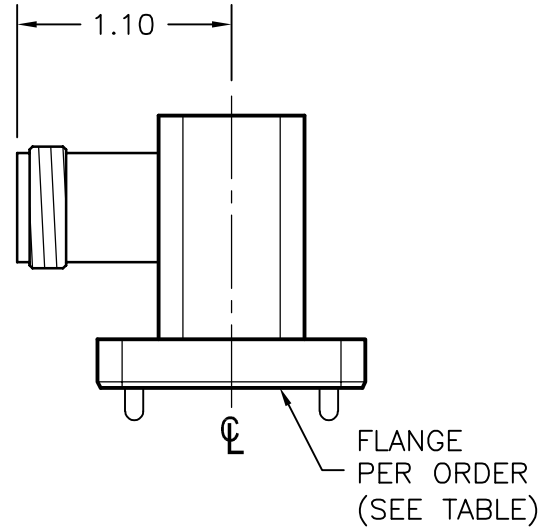
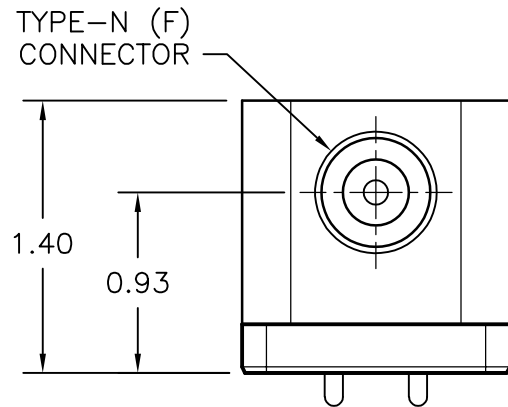

PERFORMANCE SPECIFICATIONS

MODEL NUMBER: 750-253HP-FLANGE TYPE*
 WG SIZE: WRD750
 FREQ: 7.50 - 18.0 GHz
 MAX. VSWR: 1.35
 POWER: 500W CW, 5kW PEAK
 FLANGE TYPE: SEE TABLE BELOW

*FLANGE TYPES		
C1	COVER	ALT. THRU/TAPPED
C2	COVER	ALL TAPPED
C3	COVER	ALL THROUGH
G1	GROOVE	ALT. THRU/TAPPED
G2	GROOVE	ALL TAPPED
G3	GROOVE	ALL THROUGH

THIRD ANGLE PROJECTION:		APPROVALS	DATE	ADVANCED TECHNICAL MATERIALS, INC. TEL: (631) 289-0363 FAX: (631) 289-0358 www.atmmicrowave.com		<small>THE INFORMATION IN THIS DRAWING IS PROPRIETARY AND SHALL NOT BE USED OR DISCLOSED WITHOUT THE PRIOR WRITTEN CONSENT OF ATM, INC. DO NOT SCALE DWG.</small>			
UNLESS OTHERWISE NOTED, DIMENSIONS ARE IN INCHES. TOLERANCES ARE: FRACTIONS: ±1/64 ANGLES: ±1/2° MACHINED FINISH 63 ✓ OR BETTER		DRAWN L.M.	08/07/14						
		CHKD.							
		APRVD.							
DECIMALS 2 PLACE 3 PLACE		MATERIAL -		OUTLINE, WRD750 WG-COAX		SIZE A	CAGE CODE OR8N4	ATM DWG # 16252W	REVISION B
		TREATMENT -				SCALE 1 : 1	MODEL # 750-253HP-XX	SHEET 1/1	
±.01 ±.005		FINISH STD. ATM GRAY							