

REV A	AUTH BF	DATE 2-3-09	INITIAL RELEASE
REV B	AUTH M.R.	DATE 7/27/11	PAINT CHANGED TO OPTIONAL
REV C	AUTH M.R.	DATE 08/6/12	NO DIMENSIONAL CHANGES, ADDED SIDE VIEW TO SHOW MOUNTING HOLES.

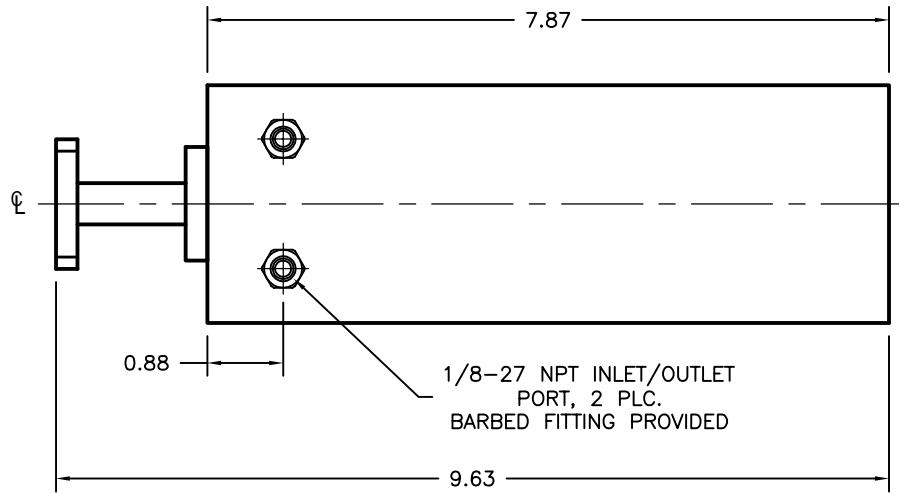
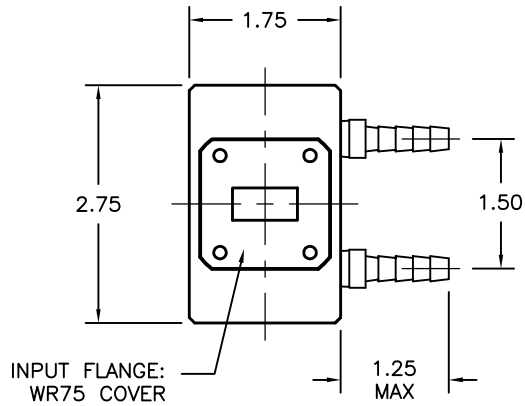
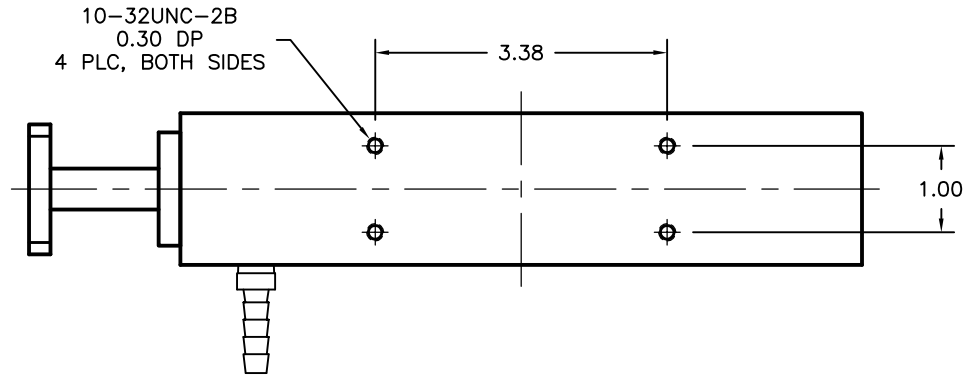

**MODEL SPECIFICATIONS**

**MECHANICAL**

MODEL NUMBER(S): 75-770-2000-6  
 MATERIAL: 6061/T-6 ALUM.  
 FINISH: CHEM FILM, HI-TEMP BLACK (OPTIONAL)  
 FLANGES: 75 COVER-TYPE, STANDARD

**ELECTRICAL**

FREQ. RANGE: 10.0 - 15.0 GHz

THIRD ANGLE PROJECTION:		APPROVALS	DATE	ADVANCED TECHNICAL MATERIALS, INC. TEL: (631) 289-0363 FAX: (631) 289-0358 www.atmmicrowave.com		THE INFORMATION IN THIS DRAWING IS PROPRIETARY AND SHALL NOT BE USED OR DISCLOSED WITHOUT THE PRIOR WRITTEN CONSENT OF ATM, IN DO NOT SCALE DWG.	
UNLESS OTHERWISE NOTED, DIMENSIONS ARE IN INCHES. TOLERANCES ARE: FRACTIONS: ±1/64 ANGLES: ±1/2°		DRAWN BF	02/03/09	<b>OUTLINE, WR75 H2O COOLED TERMINATION</b>			
BASIC DIMENSION		CHKD.	APRVD.				
DECIMALS 2 PLACE 3 PLACE							
UNDER 6"	±.02 ±.005	MATERIAL ALUM.		SIZE A	CAGE CODE OR8N4	ATM DWG # 9559	REVISION C
6" - 12"	±.03 ±.010	TREATMENT -		SCALE 1 : 2	MODEL # SEE NOTES	SHEET 1/1	
OVER 12"	±.06 ±.015	SEE NOTES					