

REVISIONS		DATE	APPROVED
ZONE	LTR	DESCRIPTION	
B		ATM RELEASE: FORMAT UPDATE	11/07/23 M/R

**MODEL SPECIFICATIONS**

**MECHANICAL**

MODEL NUMBER: 284-630HPX-XX-X-X  
 MATERIAL: WR284  
 FLANGES: WR284 PER ORDER

FINISH: STD GRAY  
 CORROSION RESISTANT EPOXY COATING

**ELECTRICAL**

FREQ. RANGE: 2.60-3.95 GHz  
 ATTENUATION: 10, 20, 30, 40, 50dB AVAILABLE  
 NOMINAL: ±0.50  
 FREQ SENS: ±0.60  
 VSWR: 1.15:1 MAX  
 POWER: 1200W

TYPICAL MODEL NUMBER (EXAMPLE): 284-630HPA-40-6-6

WAVEGUIDE SIZE: (WR DESIG.)

BASIC MODEL: 630HP=WG FIXED HP ATTENUATOR

MATERIAL: A=ALUMINUM B=COPPER/BRASS

ATTEN. VALUE: 10dB, 20dB, 30dB, 40dB, 50dB AVAIL

FLANGE 1: 1=CPRG, 2=CPRF, 6=COVER

FLANGE 2: 1=CPRG, 2=CPRF, 6=COVER

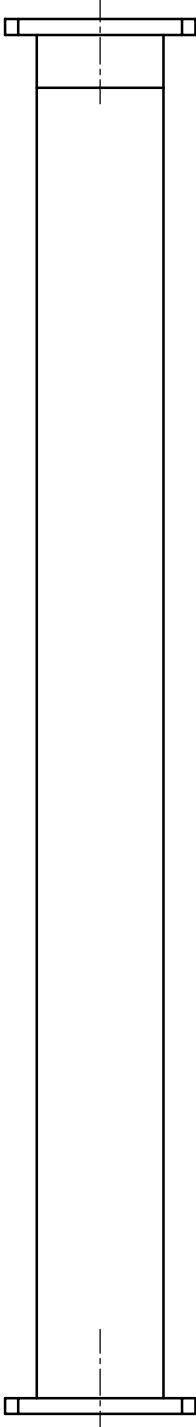

FLANGE 1 (INPUT)  
 AS PER ORDER  
 CPRF SHOWN

1.46

33.00

FLANGE 2  
 AS PER ORDER  
 CPRF SHOWN

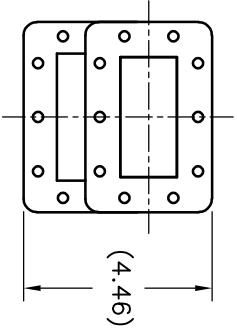

(4.46)

PRINT NOT ON AUTOMATIC DISTRIBUTION VERIFY REVISION PRIOR TO USE

FLANGE TABLE	
1	CPRG
2	CPRF
3	CMR
6	UG COVER
7	UG CHOKE

**Narda-MITTEO PROPRIETARY**  
 THIS DOCUMENT CONTAINS INFORMATION WHICH IS PROPRIETARY TO NARDA-MITTEO. THE CONTENTS SHALL NOT BE DISCLOSED, COPIED, DISTRIBUTED, OR USED UNLESS AUTHORIZED BY AN OFFICER OF NARDA-MITTEO.

THIS TECHNOLOGY CONTAINS INFORMATION SUBJECT TO U.S. GOVERNMENT EXPORT CONTROL IN ACCORDANCE WITH THE EXPORT ADMINISTRATION REGULATIONS (EAR), 15 CFR 730-744. EXPORT OF THIS DATA TO ANY FOREIGN COUNTRY OR DISCLOSURE OF THIS DATA TO ANY NON-US PERSON MAY BE A VIOLATION OF FEDERAL LAW.

UNLESS OTHERWISE SPECIFIED DIMENSIONS ARE IN INCHES TOLERANCES ON DECIMALS .XX±.01 .XXX±.005 ANGLES ±0°30'

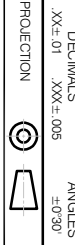

3496	DATE	02/11/03
VALUE	R/L	
M/R	APPROVED BY	
11/01/23		

**narda MITTEO**  
 436 HOBELAND BLD/HALPHOUSE, NY 11788

**OUTLINE**  
 WR284 HP FIXED ATTEN

SIZE CODE IDENT. NO. 94S46 228541

SCALE N.I.T.S. REF SHEET 1 OF 1

APPL	USED ON	FINISH
NEXT ASSY		STD GRAY
APPLICATION		

DRW/N	3496
DRAWN	
DATE	02/11/03
DESIGN	
APPROVED BY	
PROJ	
ENGR	
WKS	
ENGR	
O.A.	

SCALE	N.I.T.S.	REF	SHEET	1	OF	1
-------	----------	-----	-------	---	----	---