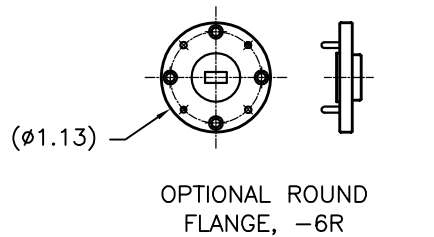
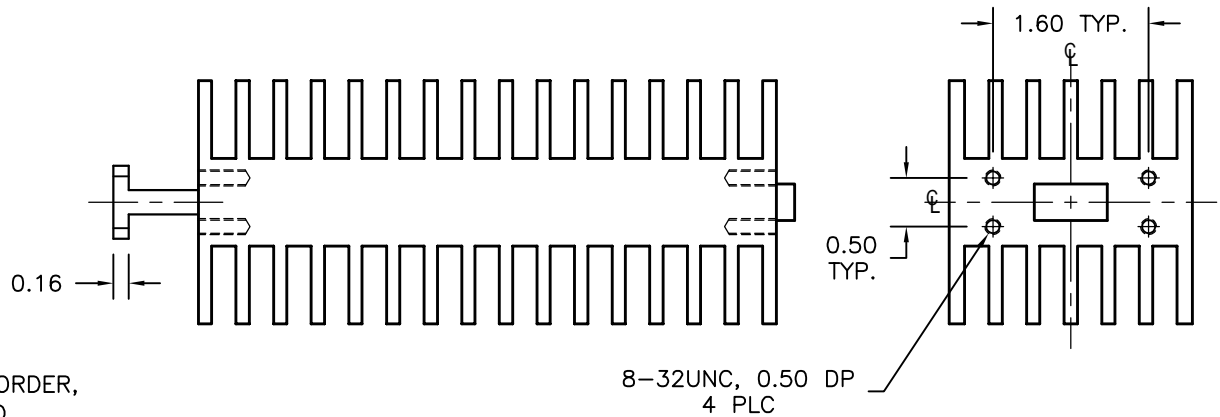
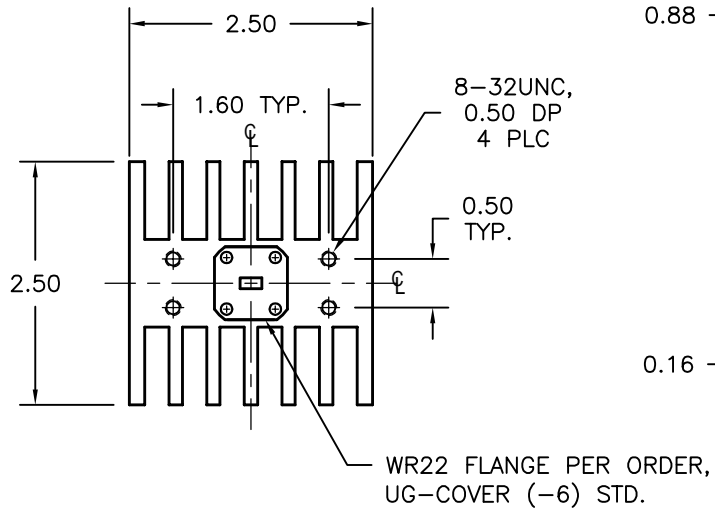
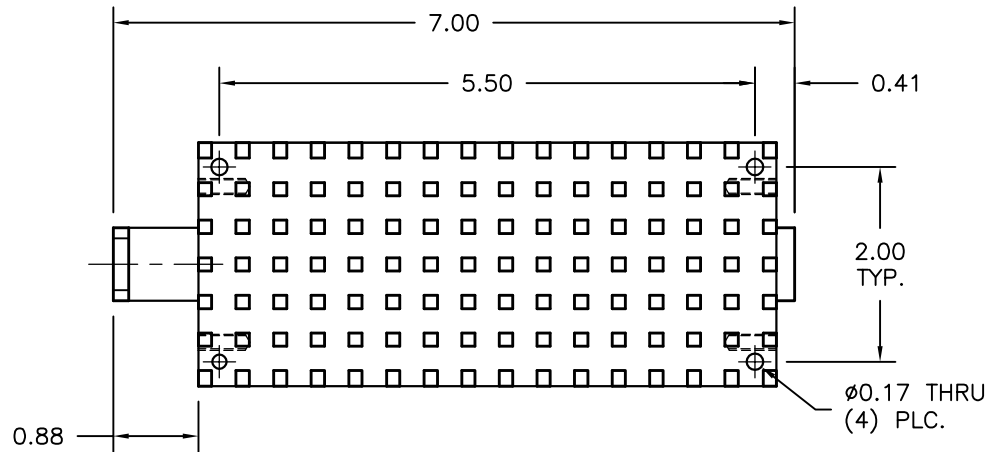

*TABLE A ATM STANDARD FLANGE TYPES	
-6:	UG-COVER
-6R:	UG-COVER ROUND
-7:	UG-CHOKE
-8:	UG COVER-GROOVE



REV	AUTH	DATE	INITIAL RELEASE.
-	R.L.	12/22/05	INITIAL RELEASE.
A	M.R.	07/17/05	INPUT W.G. SECTION UPDATED. MODEL NUMBER UPDATED, WAS 22/28-780.
B	M.R.	12/14/15	FLANGE CALLOUT CORRECTED, WAS WR28.
C	M.R.	12/21/15	PER E.C.N. 12-21-15-01 LENGTH WAS 9.00. FORMAT UPDATE. ADDED ROUND FLANGE OPTION.



MODEL SPECIFICATIONS

MODEL CODE: 22-780-X*
 WG SIZE: WR22 INPUT
 FLANGES: PER ORDER, SEE TABLE A
 FREQ. RANGE: 33.0-50.0 GHz
 VSWR: 1.15 MAX.
 AVG. POWER: 500 WATTS

THIRD ANGLE PROJECTION:		APPROVALS	DATE	ADVANCED TECHNICAL MATERIALS, INC.		THE INFORMATION IN THIS DRAWING IS PROPRIETARY AND SHALL NOT BE USED OR DISCLOSED WITHOUT THE PRIOR WRITTEN CONSENT OF ATM, INC. DO NOT SCALE DWG.	
UNLESS OTHERWISE NOTED, DIMENSIONS ARE IN INCHES, TOLERANCES ARE: FRACTIONS: $\pm 1/64$ ANGLES: $\pm 1/2^\circ$ MACHINED FINISH 63 $\sqrt{\text{OR BETTER}}$		DRAWN R.L.	12/22/05	TEL: (631) 289-0363 FAX: (631) 289-0358		<div style="text-align: center;"> <h2>OUTLINE</h2> <h3>WR22 WAVEGUIDE TERMINATION</h3> </div>	
		CHKD.		www.atmmicrowave.com			
		APRVD.					
		MATERIAL ALUM					
DECIMALS 2 PLACE 3 PLACE	TREATMENT CHEM FILM	SIZE A	CAGE CODE OR8N4	ATM DWG # 6551W	REVISION C		
± 0.01 ± 0.005	FINISH HI-TEMP BLACK	SCALE 1 : 1	MODEL # SEE SPECS			SHEET 1/1	