

REV A	AUTH MR	DATE 2/28/00	INITIAL RELEASE
REV B	AUTH RL	DATE 6/4/03	REVISED TABLE: LINE 5: A WAS 1.8, B WAS 2.0, C WAS .90, D WAS 1.0, E WAS 1.31, F WAS 1.0 G WAS .50
REV C	AUTH RL	DATE 9/12/03	REVISED TABLE: LINE 5 WAS 2.00, B WAS 1.50 C WAS 1.00, D WAS 1.00, E WAS 1.31, F WAS 1.00, G WAS: .60
REV D	AUTH RL	DATE 08/20/07	TITLE BLOCK UPDATED

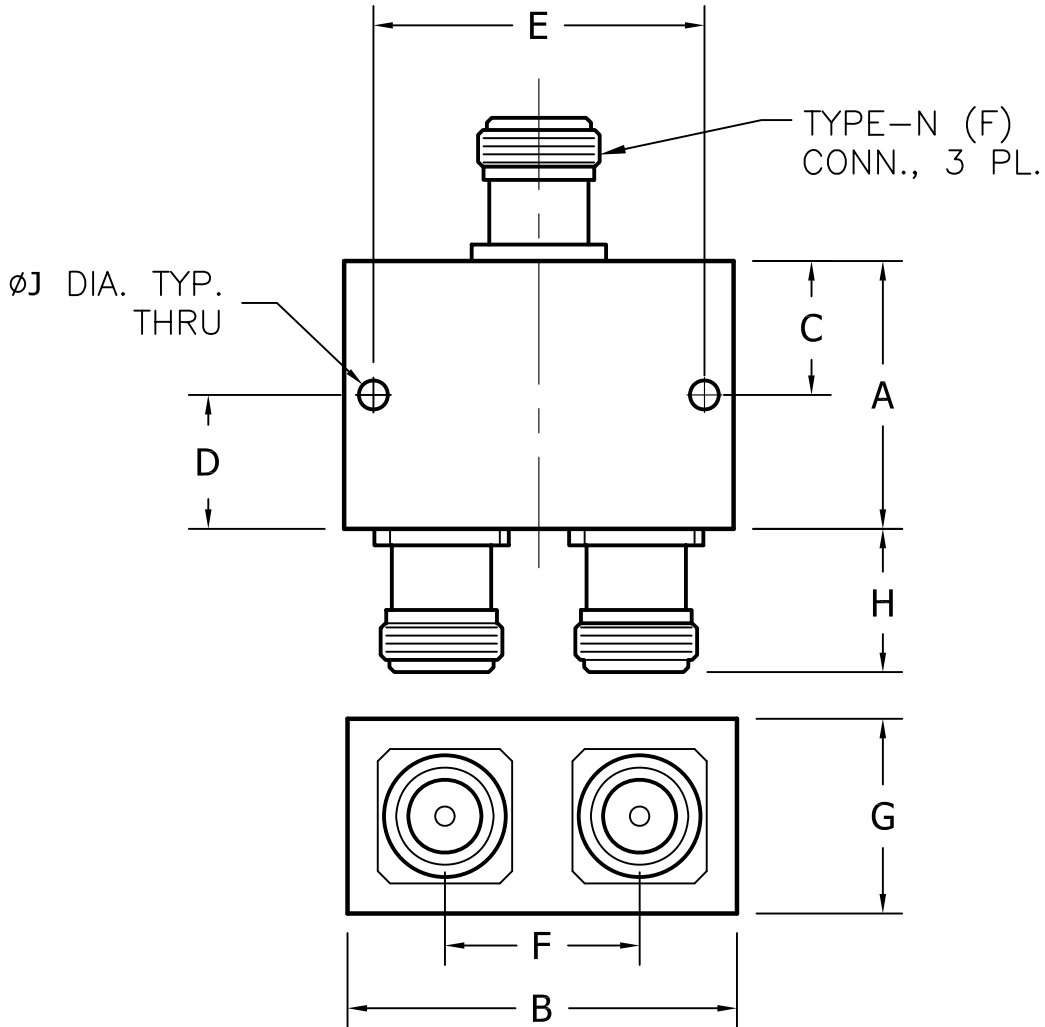

DIMENSIONS IN INCHES									
FIG	A	B	C	D	E	F	G	H	J
1	2.00	2.00	1.00	1.00	1.500	1.00	0.75	0.77	0.125
2	1.00	2.00	0.50	0.50	1.700	1.00	1.00	0.77	0.125
3	1.38	2.00	0.69	0.69	1.700	1.00	1.00	0.77	0.149
4	1.20	1.50	0.60	0.60	1.000	1.00	0.40	0.95	0.104
5	1.80	2.00	0.90	0.90	1.750	1.18	0.50	0.95	0.105

THIRD ANGLE PROJECTION:		APPROVALS		DATE		<b>ADVANCED TECHNICAL MATERIALS, INC.</b> TEL: (631) 289-0363 FAX: (631) 289-0358 www.atmmicrowave.com		THE INFORMATION IN THIS DRAWING IS PROPRIETARY AND SHALL NOT BE USED OR DISCLOSED WITHOUT THE PRIOR WRITTEN CONSENT OF ATM, INC. DO NOT SCALE DWG.	
UNLESS OTHERWISE NOTED, DIMENSIONS ARE IN INCHES, TOLERANCES ARE: FRACTIONS: $\pm 1/64$ ANGLES: $\pm 1/2^\circ$		DRAWN M ROTUNDA		2/28/00					
		CHKD.							
		APRVD.							
BASIC DIMENSION		DECIMALS 2 PLACE		3 PLACE		OUTLINE, TYPE-N POWER COMBINER/DIVIDER, 2 WAY		REVISION D	
UNDER 6"		$\pm .02$		$\pm .005$					
6" - 12"		$\pm .03$		$\pm .010$					
OVER 12"		$\pm .06$		$\pm .015$		MATERIAL PER ORDER		SCALE NONE	
		TREATMENT -		FINISH -		CAGE CODE 0R8N4		ATM DWG # 2350W	
						MODEL # P22X		SHEET 1/1	