

REV	AUTH	DATE	INITIAL RELEASE
-	-	02/27/07	

MATERIAL	EQUIVALENT TO:	
BRASS	UG 1356/U	MIL-F-3922-52-039
ALUM.	UG 1357/U	MIL-F-3922-52-040

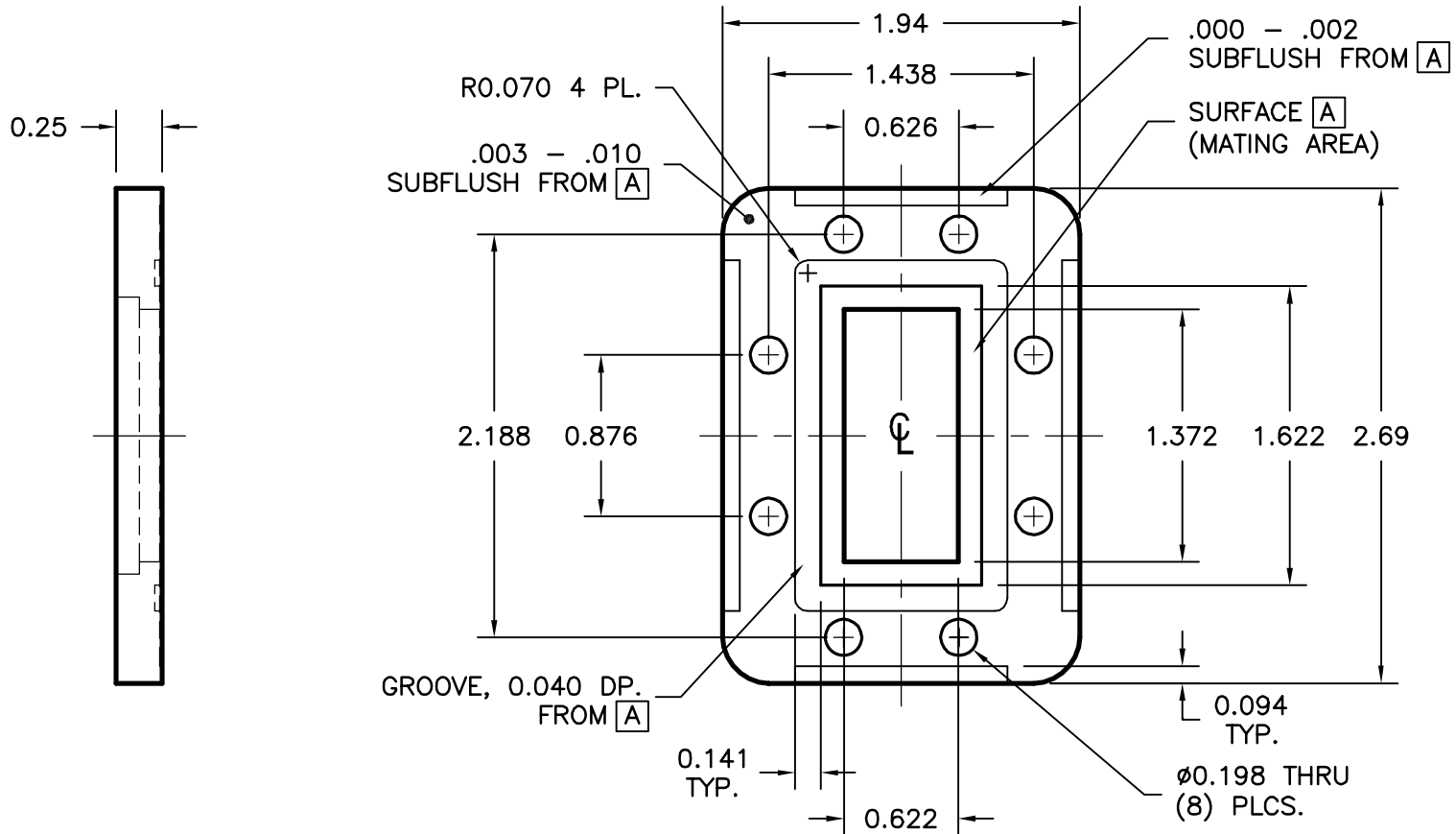

NOTES:

- ALL DRAWINGS INDICATE APPLICABLE MATING DIMENSIONS. NON INTERFACE VARIABLES SUCH AS THICKNESS, CORRAL DIMENSIONS, AND MATERIALS MAY VARY DEPENDING ON PRODUCT CONFIGURATION.

THIRD ANGLE PROJECTION:		APPROVALS	DATE		ADVANCED TECHNICAL MATERIALS, INC. TEL: (631) 289-0363 FAX: (631) 289-0358 www.atmmicrowave.com		THE INFORMATION IN THIS DRAWING IS PROPRIETARY AND SHALL NOT BE USED OR DISCLOSED WITHOUT THE PRIOR WRITTEN CONSENT OF ATM, INC. DO NOT SCALE DWGS.	
UNLESS OTHERWISE NOTED, DIMENSIONS ARE IN INCHES, TOLERANCES ARE: FRACTIONS: ±1/64 ANGLES: ±1/2°		DRAWN RL	02/27/07		WR137 FLANGE, CPR137G			
BASIC DIMENSION	DECIMALS 2 PLACE 3 PLACE	C/CHKD.	APRVD.	SIZE A				
UNDER 6"	±.02 ±.005	MATERIAL SEE NOTES		SCALE 1 : 1	MODEL # -	SHEET 1/1		
6" - 12"	±.03 ±.010	TREATMENT -						
OVER 12"	±.06 ±.015	FINISH -						