

2

1

REVISION HISTORY			
REV	AUTH	DATE	DESCRIPTION
A	-	5/28/2008	INITIAL RELEASE
B	BF	7/22/2008	ADD 1/4-20 HOLES FOR MTG
C	M.R.	11/17/2009	2.0-8.0 GHz MODEL# CORRECTED, WAS T50024F

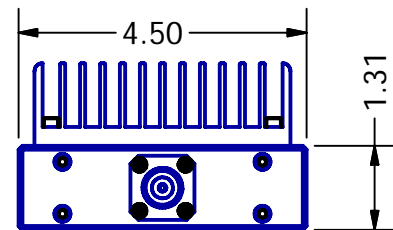
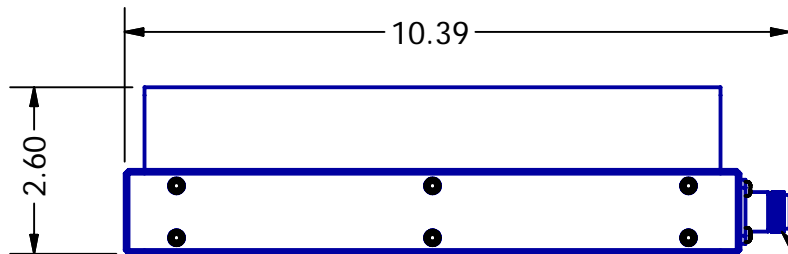

TYPE-N (F) CONNECTOR

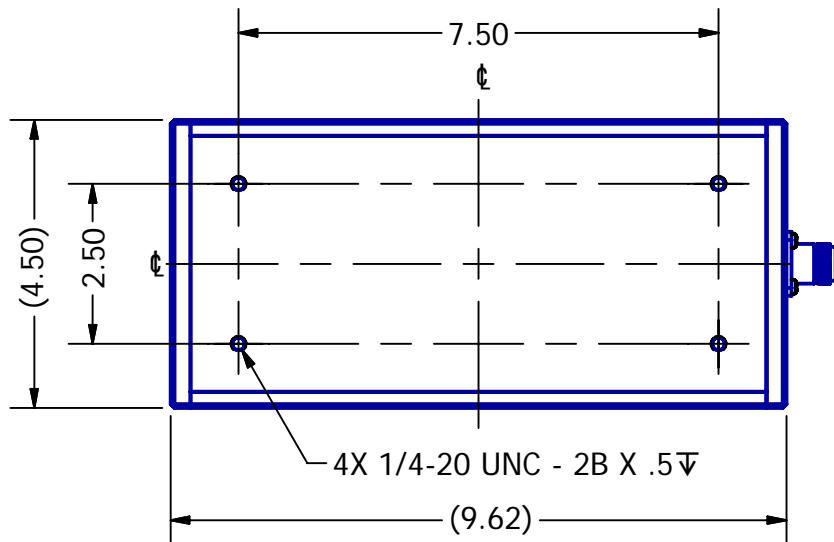

POWER RATING: 500 WATTS

FREQUENCY (Ghz)	VSWR			Model #
2.0 - 4.2	2.0 - 2.4 1.5:1	2.4 - 3.0 1.45:1	3.0 - 4.2 1.30:1	T50024
2.0 - 8.0	2.0 - 2.4 1.5:1	2.4 - 3.0 1.45:1	3.0 - 8.0 1.30:1	T50024E
3.7 - 8.4	1.30:1			T50025
2.0 - 12.4	2.0 - 2.4 1.5:1	2.4 - 3.0 1.45:1	3.0 - 12.4 1.30:1	T50024G
3.0 - 12.4	1.30:1			T50025G

NOTE:
FINISH: BLACK ANODIZE OR HIGH TEMP BLACK PAINT

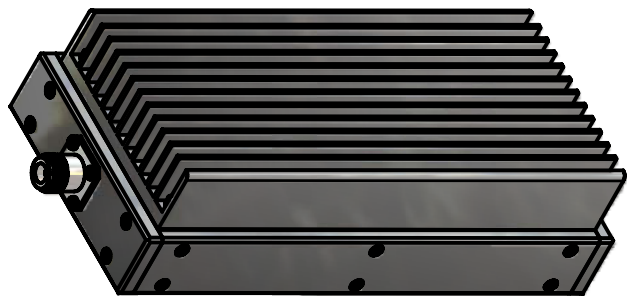

THIRD ANGLE PROJECTION:		APPROVALS	DATE	ADVANCED TECHNICAL MATERIALS, INC. TEL: (631) 289-0363 FAX: (631) 289-0358 www.atmmicrowave.com		<small>THE INFORMATION IN THIS DRAWING IS PROPRIETARY AND SHALL NOT BE USED OR DISCLOSED WITHOUT THE PRIOR WRITTEN CONSENT OF ATM, INC. DO NOT SCALE DWG.</small>	
UNLESS OTHERWISE NOTED, DIMENSIONS ARE IN INCHES, TOLERANCES ARE: FRACTIONS: ±1/64 ANGLES: ±1/2°				DRAWN BF 5/28/2008		OUTLINE, COAX TERMINATION SIZE A CAGE CODE 0R8N4 ATM DWG # 8799 REVISION C MODEL # SEE NOTES SHEET 1 OF 1	
BASIC DIMENSION		DECIMALS 2 PLACE 3 PLACE		CHKD. MR 5/28/2008			
UNDER 6"		±.02 ±.005		APRVD. MB 5/28/2008			
6" - 12"		±.03 ±.010		MATERIAL AL ALY TYPE 6061-T6 BODY			
OVER 12"		±.06 ±.015		TREATMENT			
				FINISH SEE NOTES			

2

1